

record DFA 127

automatic drive system for swing doors



record DFA 127



record

your global partner for entrance solutions

record DFA 127

automatic drive system for swing doors

Brief Description

The record DFA 127 is a universal drive system for the automation of swing doors, characterised by sophisticated technology, compact design and a smoothness of operation for which record has become renowned. The focus on a broad range of applications makes it a full-fledged drive, suitable for widely differing requirements.

Its universal qualities are due to its electromechanical construction and modular design, enabling it to be visibly mounted to a variety of surfaces above a swing door entrance, or concealed in a ceiling cavity with an extended spindle for the connection arm.

When the swing door drive motor operates, it tensions a spring integrated in the drive housing. When the door closes, the energy stored in the spring is utilised, with motor assistance employed if required in high wind areas or for larger door panels.

Drive Types

- full power: versatile and strong, optimised for the use of large, heavy doors in external applications.
- low energy: gentle and responsive, limiting the kinetic energy to allow the door to be used safely without infrared sensors.
- inverse: caring and safe, opening by spring force automatically with loss of mains power for free egress or smoke ventilation.
- fire: secure and reliable, when used with various fire protection profile systems to provide closure of a door in a fire emergency.

Features:

- operating modes: Automatic, Hold Open, Manual, Locked, Exit
- functions: Auto reverse, Push and Go, Emergency stop, 2 leaf synchronised operation, Interlock
- drive housing: stainless steel (standard) or aluminium.

Door Leaf Weights:

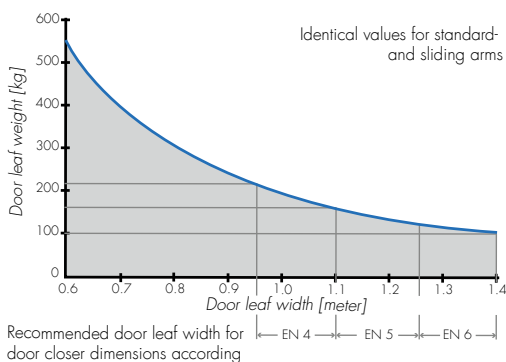

Compliance

record DFA 127 operators meet the Building Code of Australia (BCA) requirements and are tested to stringent European standards DIN EN16005 (durability and safety).

record complies with the design, safety and functionality guidelines of the non-legislative Australian Standard AS5007:2007.

Technical Specifications

| | |
|------------------------|-------------------------------|
| Dimensions (H x W x L) | 85mm x 124mm x 600mm |
| Opening / Closing Time | 3 - 20 sec / 5 - 20 sec |
| Power supply | 230VAC, 50 Hz |
| Power consumption | 67W Power mode, 13W standby |
| Operating angle | 70° - 115°, INVERSE up to 95° |
| Protection rating | For use in dry locations only |
| Ambient temperature | -15°C to +50°C |
| Door closer size | EN4 to EN6 |

Operation Installation

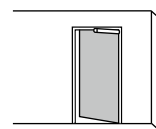

Lintel installation (1-leaf door)
Standard bars, DIN left or right, pushing; drive variant for pushing sliding bars available

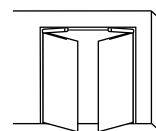

Lintel installation (2-leaf door, master/slave operation)
Two electrically coupled drives with standard arm pushing or slide arm pulling

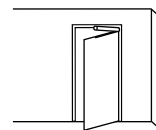

Lintel installation (1-leaf door)
Slide arm DIN left or right pulling

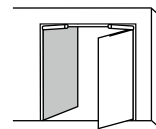

Lintel installation (2-leaf door width two-way traffic)
Alternating operation of two drives that are independent of each other

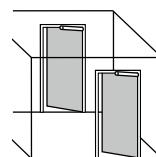

Interlock operation (2 x 1-leaf doors standing one after the other)
Two electrically interconnected drives in all arm variants

Drawings (V arm)

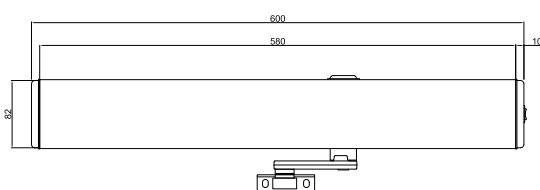
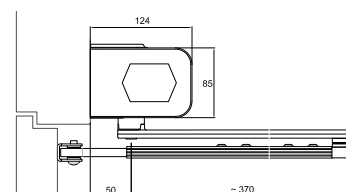

→ record Automatic Doors Pty Ltd – www.recorddoors.com.au

Melbourne: 119 Metrolink Circuit, Campbellfield VIC 3061

Phone: +61 3 8339 2888 – 1300 804 438 – infomelbourne@recorddoors.com.au

Sydney: 30 Prince William Drive, Seven Hills NSW 2147

Phone: +61 2 8811 4000 – 1800 674 408 – infosydney@recorddoors.com.au

record DFA 127

White Bay Cruise Terminal | Rozelle NSW Australia



CASE STUDY



AW Edwards **Builder**
Johnson Pilon Walker **Architect**
2041 James Craig Road, Rozelle **Address**
2013 **Year**

An historic part of Sydney's working port, with sweeping harbour views from the Harbour Bridge to the the Anzac Bridge, was reinvented in 2013 to create the White Bay Cruise Terminal. To pay homage to this maritime heritage the design of the building incorporates the existing structure from the gantry system originally used for a containerised shipping service in the 1960's.

Products from record Automatic Doors were used exclusively throughout the terminal, including 2 x Fullview revolving doors, 11 x STA 20 automatic sliding doors and a total of 18 x DFA 127 automatic swing doors, which included 8 to the main entry (pictured below).

In this area the operators work in pairs with the right hand door opening before, and closing after, the left hand door. During normal operation on shipping days, the swing doors open via a signal from photo electric sensors mounted on free standing bollards, allowing the doors to open early to accommodate the large traffic flows experienced by the terminal.



record DFA 127

Meriton Head Office | Sydney NSW Australia



CASE STUDY

When Meriton was looking to upgrade the tired entrance lobby of their Sydney head office, they engaged record Automatic Doors to assist with automating their main entrance.

Working directly with Meriton's in house design team, the existing manual swing doors were replaced with a pair of frameless glass swing doors, one being larger to create an automatic entrance meeting necessary DDA requirements.

A new aluminium transom was fitted to support a record DFA 127 operator with radar activation sensors mounted on both sides for automatic operation in business hours, with a card reader mounted outside and push button inside for after hours access.

To provide a striking signature entrance for Meriton, record organised for the Meriton logo to be custom crafted into brass 500mm high x 500mm wide back to back door handles, weighing 20kg each, and mounted to the door wings.



record DFA 127

Commonwealth Bank Place | Sydney NSW Australia



CASE STUDY



Lendlease **Builder**

FJMT **Architect**

1 Harbour Street, Sydney **Address**

2011 **Year**

Commonwealth Bank Place, situated in Sydney's Darling Harbour precinct, showcases a number of products from record Automatic Doors, including two Diamond Series revolving doors to the main lobby entries, one Fullview Series revolving door to an upper lobby entrance, four STA 20 automatic sliding door operators to car park and internal entries and three DFA 127 automatic swing door operators to the lobby entries.

The DFA 127 swing door operator provides automation to frameless glass swing doors to meet disabled access requirements. In this application the DFA 127 was concealed within a painted mild steel fabricated transom that is set back 180mm from the door position.

The doors are secured via ES 8000 V locks concealed in the transom and activated by card reader and push button externally, and push button and break glass internally.

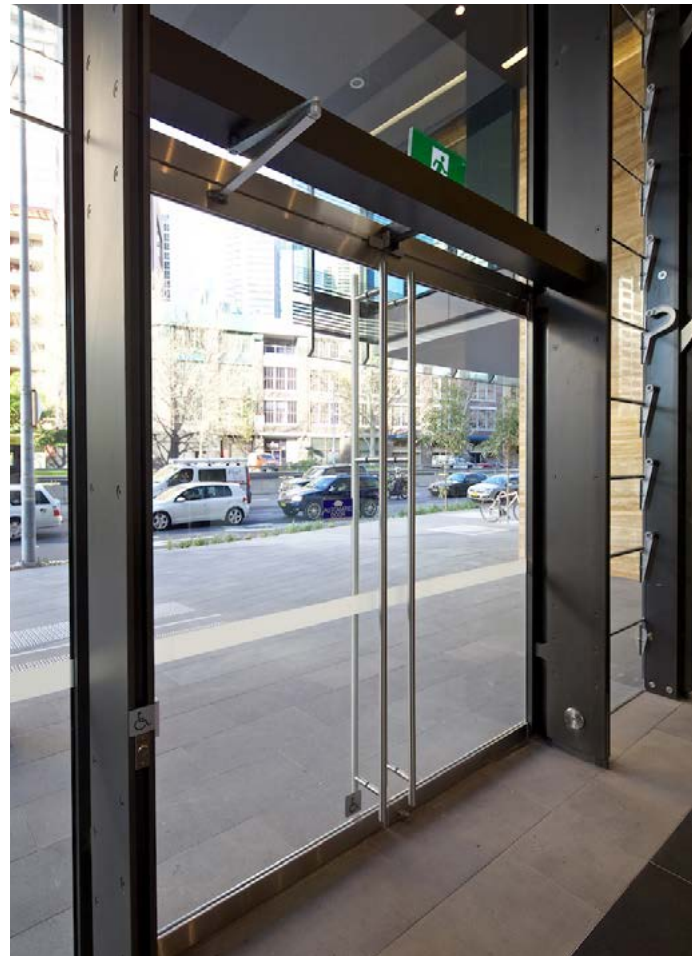

record DFA 127

NDIS Head Office | Chatswood NSW Australia



CASE STUDY



Rork Projects **Builder**
67 Albert Avenue, Chatswood **Address**
2017 **Year**

For the refurbished government offices of the National Disability Insurance Scheme in Chatswood, record Automatic doors was selected to undertake the supply and installation of the automatic door package.

Included in this work was the supply, installation and commissioning of four DFA 127 swing door operators to accessible bathrooms and secured meeting rooms.

The bathroom doors were configured to operate via record's accessible bathroom control plate system with a push to open button and occupancy LED indicator lights outside, and a push to lock button and lock indicator lights mounted inside.

The secured meeting room doors operate via card reader outside and push button inside.

Also included in the package was three STA 21au automatic sliding door operators to the main entrance and internal office entrance areas.



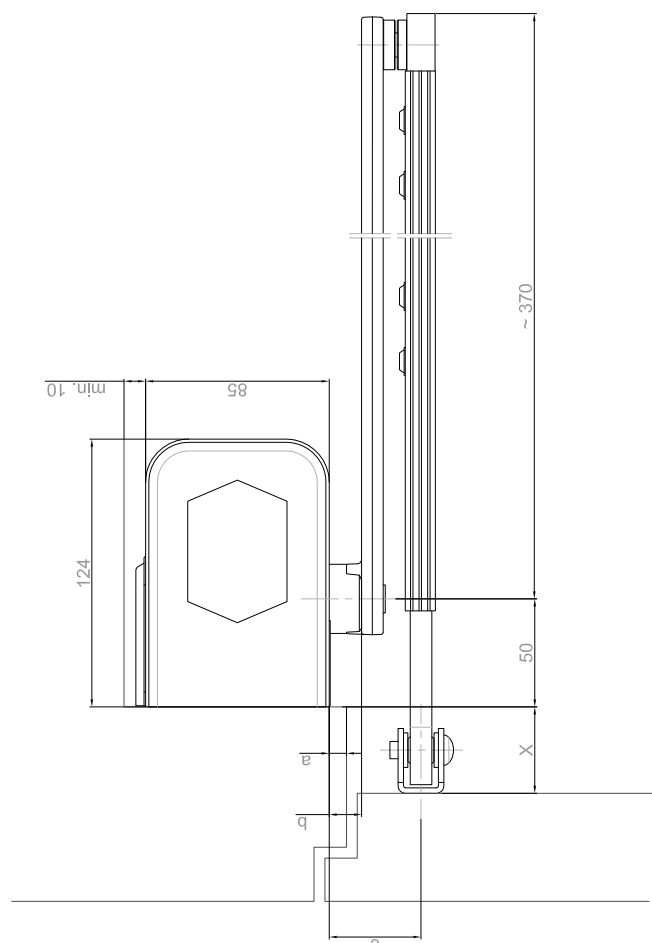
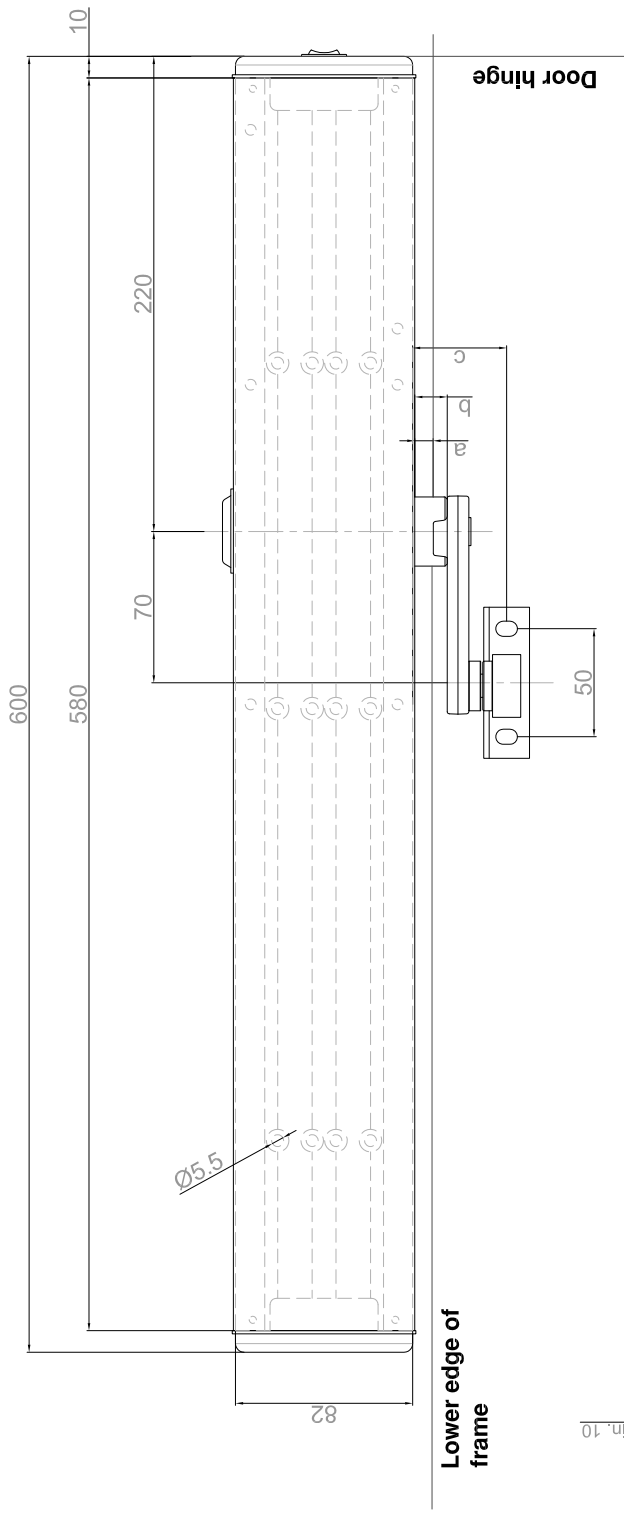

| (Dimensions in mm*) | Lever adapter 20 | Lever adapter 50 | Lever adapter 65 | Lever adapter 80 |
|---------------------|------------------|------------------|------------------|------------------|
| a | 8 | 38 | 53 | 68 |
| b | 15 | 45 | 60 | 75 |
| c (= ,D') | 42.5 | 72.5 | 87.5 | 102.5 |

* The indication of measurements corresponds to the lower edge of the operator. If the measure is taken from the lower edge of the chassis, + 1.5mm must be added

| Lintel dimension X (Dimensions in mm) | Article number |
|---------------------------------------|----------------|
| SG 1 | 127.808.184 |
| SG 2 | 127.808.215 |
| SG 3 | 127.808.216 |



record automatic doors pty ltd ABN: 58 601 122 874
Melbourne 119 METROLINK CIRCUIT
 119 METROLINK CIRCUIT CAMPBELLFIELD, VICTORIA 3061
 T: + 61 3 8339 2888 E: infomelbourne@recorddoors.com.au
Sydney 30 PRINCE WILLIAM DRIVE
 SEVEN HILLS, NSW 2147
 T: + 61 2 8811 4000 E: infosydney@recorddoors.com.au

MODEL: **DFA127 Std V Arm, Push**
 PROJECT: **Lintel Mount**
 Drawn: **GW**
 Date: **Nov 15**
 Scale: **1:20**
 Dwg no: **DFA127_01**

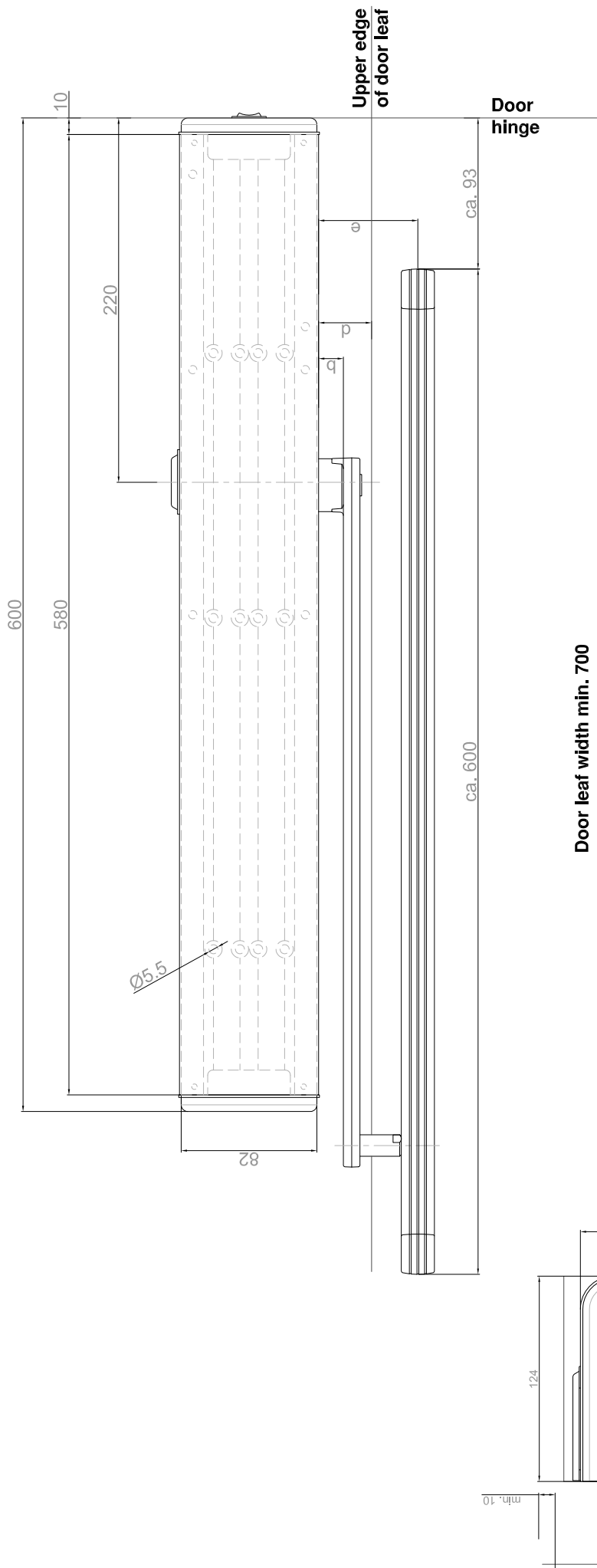

Door leaf width min. 700

| (Dimensions in mm*) | Lever adapter 20 127.808.211 | Lever adapter 50 127.808.212 | Lever adapter 65 127.808.218 | Lever adapter 80 127.808.213 |
|---------------------|---------------------------------|---------------------------------|---------------------------------|---------------------------------|
| b | 15 | 45 | 60 | 75 |
| d (= 'D') | 32 | 62 | 77 | 92 |
| e | 60 | 90 | 105 | 120 |

* The indication of measurements corresponds to the lower edge of the operator. If the measure is taken from the lower edge of the chassis, + 1.5mm must be added

| Lintel dimension (Dimensions in mm) | Article number |
|--|----------------|
| GG +/- 10 | 127.808.183 |

record automatic doors pty ltd
Melbourne
 119 METROLINK CIRCUIT
 CAMPBELLFIELD, VICTORIA 3061
 T: + 61 3 8339 2888
 E: infomelbourne@recorddoors.com.au

ABN: 58 601 122 874
Sydney
 30 PRINCE WILLIAM DRIVE
 SEVEN HILLS, NSW 2147
 T: + 61 2 8811 4000
 E: infosydney@recorddoors.com.au

MODEL: **DFA127, slide arm, pull** Drawn: **GW**

Lintel Mount Date: **Dec 15**

PROJECT: Scale: **1:20**

Dwg no: **DFA127_02**

